

Product features:

- completely concealed hinge,
- 3D adjustable (vertical ± 2.5 mm, horizontal ± 2.5 mm, depth ± 1 mm),
- slide bearings - do not require lubrication,
- right and left doors applicable,
- main dimensions: height 160 mm, width 28 mm, depth 36
- distance between bodies 18 ± 1 mm



Fire rating 60' according EN 1634-2 norm – EI 60



Successfully passed 200,000 open/close cycle tests with load 100 kg

Successfully passed 600,000 open/close cycle tests with load 80 kg

Classification according EN 1935: 4 7 5 0 1 0 0 12



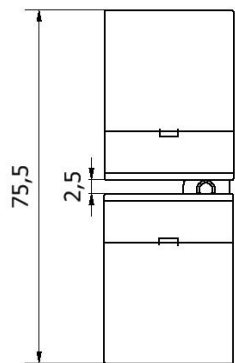

DOOR SIDE FRAME SIDE

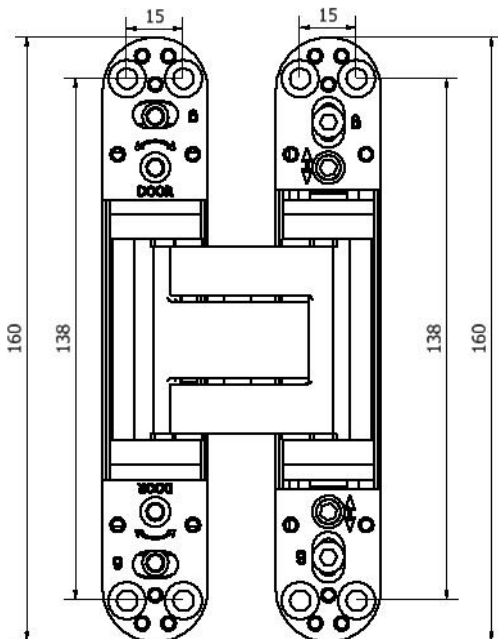
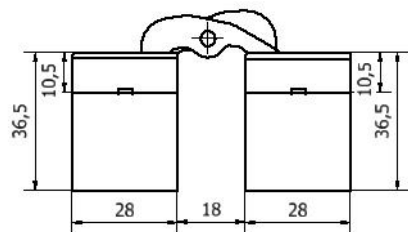

ADJUSTMENT METHODS

To make adjustments will be needed 4 mm Allen key. Adjustment is corrected when all hinges carrying the load.

A – vertical adjustment – range $\pm 2,5$ mm

Loosen both blocking screws (1) and make sure that the top adjustment screw (2) is on par with the front surface of the hinge - if not must unscrew it for this position. Adjust the hinge by turning bottom adjustment screw (2). After finished adjustment tighten both blocking screws (1).

B – depth adjustment – range ± 1 mm

C – horizontal adjustment – range $\pm 2,5$ mm

Depth adjustment and horizontal adjustment takes place simultaneously. Loosen both blocking pins (3) and adjust the hinge by turning alternately of both eccentric screws (4). After finished adjustment tighten both blocking screws (3).

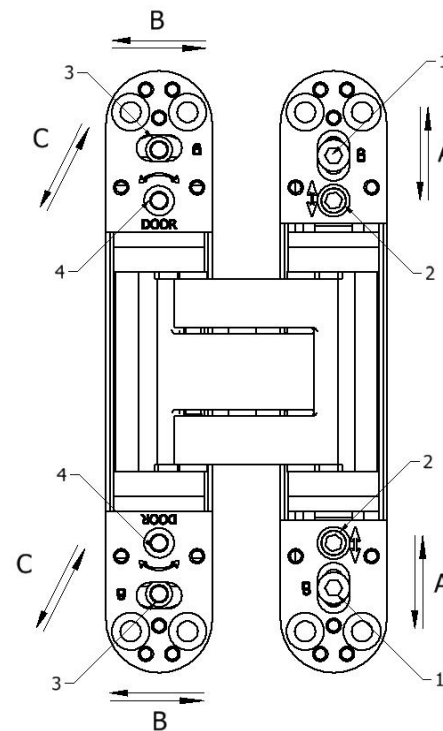
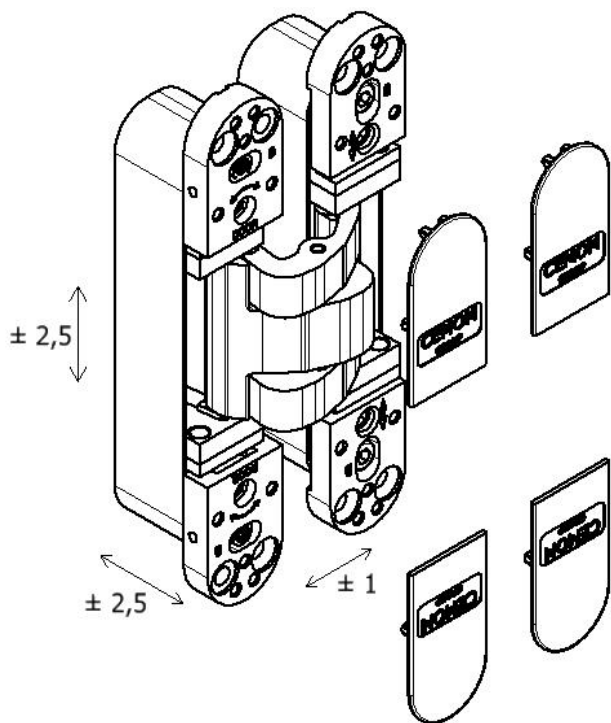

ARRANGEMENT OF HINGES

With correct adjustment (all hinges carrying the load), the suggested admissible weight of a door depending on the number of hinges and the door width, at the wing height of 2000 mm minimum has been presented in the table. The first door should always be checked.

Number of hinges	width DOOR "L"				
	600	700	800	900	1000
2	110 kg	106 kg	102 kg	100 kg	90 kg
3	124 kg	119 kg	115 kg	112 kg	100 kg
4	138 kg	133 kg	125 kg	125 kg	112 kg

Position of the hinge in relation to the required dimensions of the door and the frame

Thickness of the door "G"	Width of the DOOR "L"				
	600	700	800	900	1000
	Minimum gap „B"				
36 mm	2mm	2mm	2mm	2mm	2mm
40 mm	2mm	2mm	2mm	2mm	2mm
60 mm	4mm	4mm	3mm	3mm	3mm
80 mm	6mm	6mm	5mm	4mm	4mm

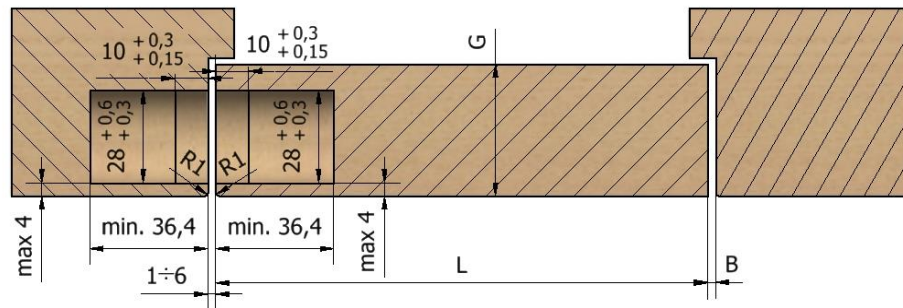

Two hinges

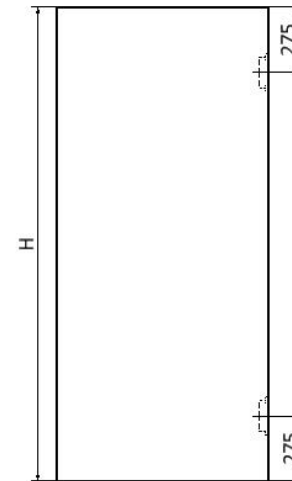

Three hinges

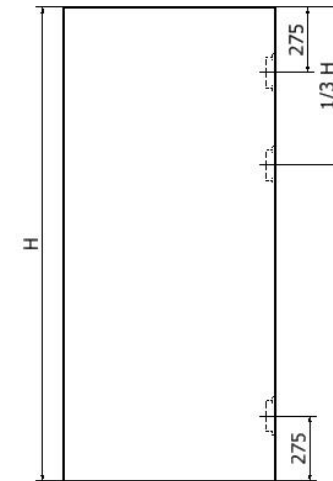

Four hinges

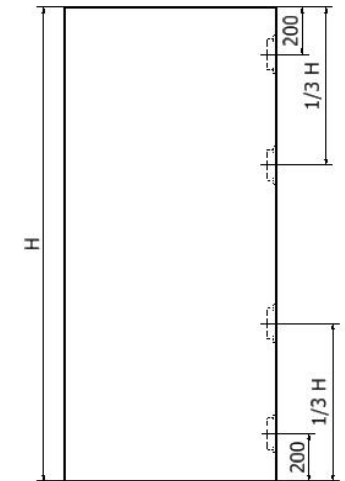

Hmin = 2000

MILLING DIMENSIONS

FRAME SIDE

DOOR SIDE

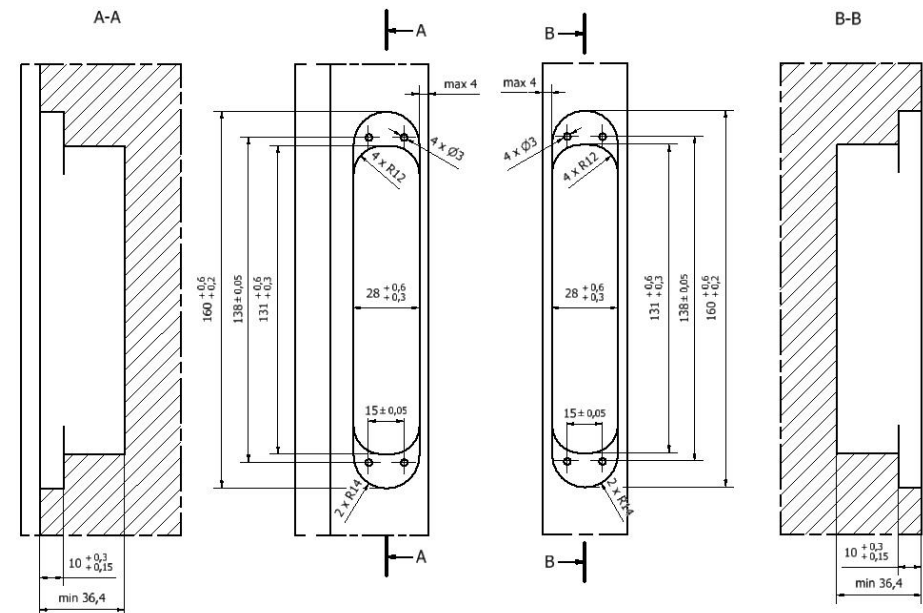

3/4

Mounting accessories

mounting plate 100-10-01

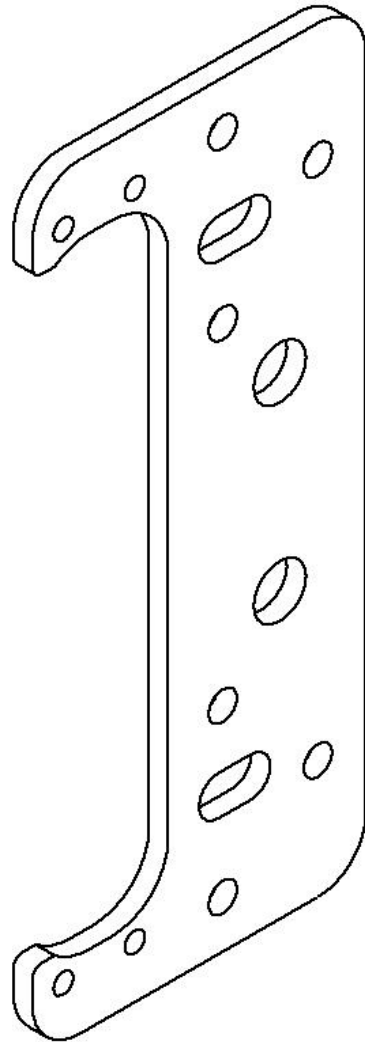

Universal milling frame: UMF-00-00

